

The Ashtons logo is displayed in white text on a dark blue rectangular background in the top right corner. The word "Ashtons" features a green swoosh underline under the letter 'A'.

# Ashtons



8 Drummond House College Mews YO31 7SH

£1,200 PCM

2



2



1



C

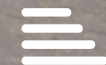



**\*\*WE ARE NOW FULLY BOOKED FOR VIEWINGS ON THIS PROPERTY\*\***

A two bedroom apartment on a popular residential development in Heworth just a short walk from the city centre. Offered for let on an unfurnished basis the property comprises of entrance hall leading through to an open plan living kitchen area. The kitchen is equipped with oven, hob, integrated fridge freezer and washing machine whilst the living space benefits from views over the communal gardens. There is a master bedroom with ensuite shower room, a second double bedroom and house bathroom. The apartment also benefits from an allocated parking space.

Available 11th September / Deposit £1300 / 12 Month Tenancy / EPC Rating C / Council Tax Band C / One allocated parking space

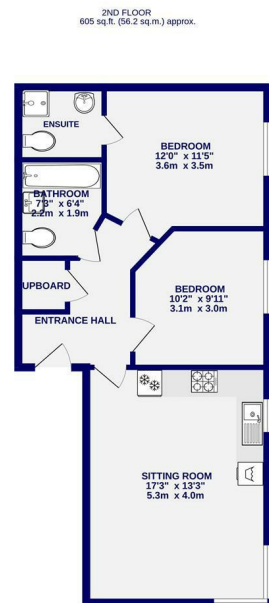

TOTAL FLOOR AREA: 605 sq. ft. (56.2 sq. m.) approx.  
While every effort has been made to ensure the accuracy of the floorplan, measurements of rooms and any other areas are approximate. It is advised to take the measurements of the rooms and any other areas as a guide only. The floorplan is not intended to be used as a basis for any legal proceedings. The plan is for information only and should be used in conjunction with the verbal description. The plan is for information only and should be used in conjunction with the verbal description. The plan is for information only and should be used in conjunction with the verbal description.



Ashtons Lettings

01904 731404

lettings@ashtonsnet.com